

TECHNICAL RIDER

Minuit Copagnie: « Sodade »

We give a special importance to this document which is part of the contract.

Our focus is to present the show in the best conditions and everybody's effort will be part of this.

Don't hesitate to contact us if one particular point bothers you. We will do our best to solve it together and to adapt for the best outcome.

-Show:

-Audience capacity: 1500 persons for bi-frontal representation (750 persons on each side of the structure)

-Running time: 50 minutes.

-Audience seat down on the floor it's the best, prevent carpet. If you want to install tiers, chairs or bench, thanks to warn you in order to reflect about their proper place.

-This show is designed to be played at night or in darkness. The best is to start the show at sunset. This configuration allows playing the last fifteen minutes in complete darkness (see www.leshorairesdusoleil.com). Plan to shut down the public lightings.

-Performing area:

-A 13 meters (depth) to 13 meters (width) with a 9 meters high clearance is mandatory for the building of the structure (trailer), sound and lights.

-The stage space must be closed to public access with a barrier system (20 barriers "Vaubans" , rubalise...) before the company arrival and till one hour before the show.

- This show can be played as outdoors; it is best fitting to "protected places": square, parks...

-Transport and Access:

-The material is transported in a container 40 feet, to envisage a space of unloading near the performing area. We need 15 m behind the container to unload the trailer.

- If the equipment cannot be unloaded on site, contact us to find a solution.

- The unloading must be with the company team.

- Trailer's characteristics:

Weight: 2 600 kilograms – 5732 pounds

Length: 8, 30 meters

Width: 2, 25 meters

Height: 2, 20 meters

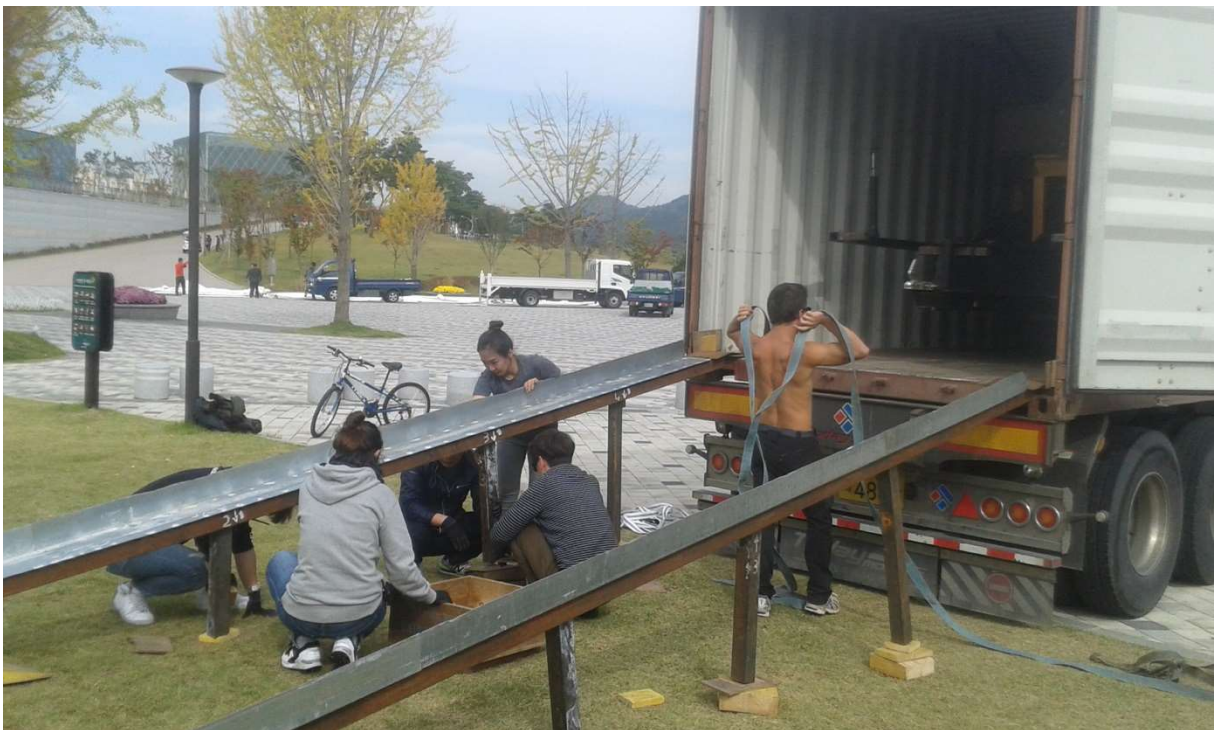

-Layout plan :

m = meter
1m = 1,09 yard

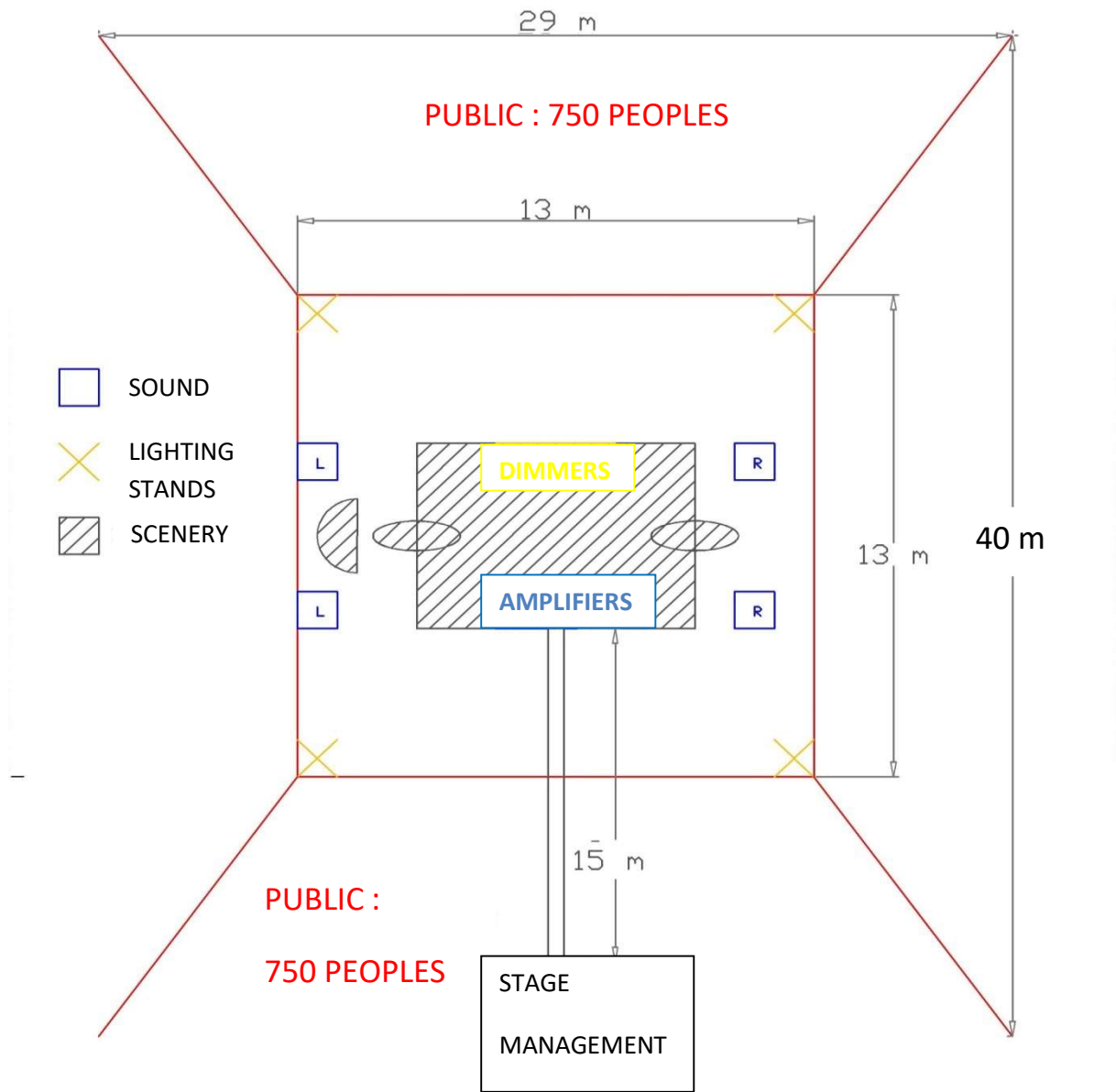

-Sectional drawing of the structure:

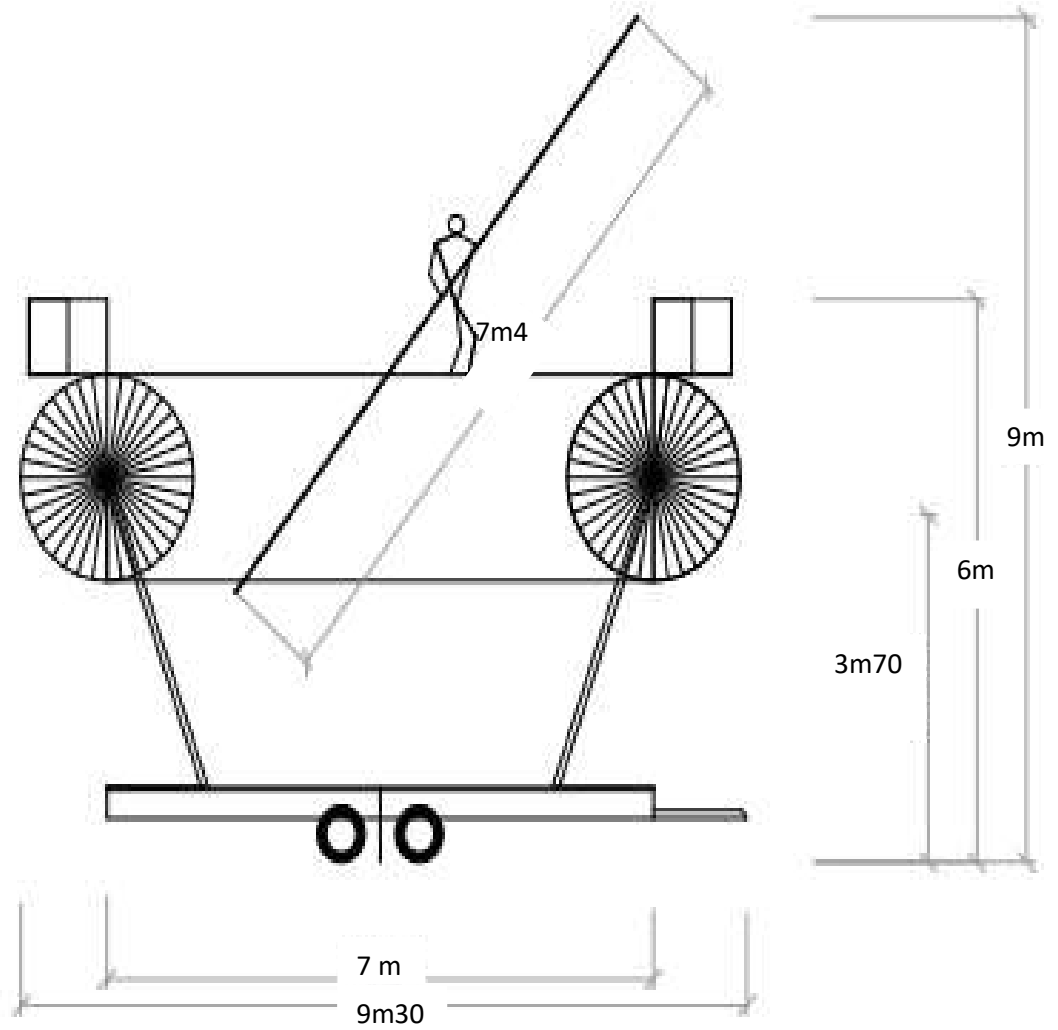

-Electricity:

- One electrical cabinet 63 A tetrapolar (under the structure) for the light with 2 electrical outlets (16 A/220 V) and one electrical outlets for dimmer.

- One electrical cabinet 16 A tetrapolar for the sound (not the same as the light) with one electrical outlet (16A /220 V) and electrical outlets for the P.A.

-These electrical cabinet should be under the scenery (see plan).

- Plan 15m cable bridges for the snake and plan the required cable bridges for the power supply cable.

-Plan 12 electrical adaptors if necessary (between French plug and your socket)

- Plan 1 CO2 fire extinguishers.

-Lights:

List of equipment required from the organizer:

- 26 PAR 64 LONG with lamp 1000 W CP62 (MFL: 11-24°) (with outside focus) with clamp, and plan 3 spares lamp.

- 2 PAR 64 SHORT with lamp 1000 W CP62 (MFL: 11-24°) (with outside focus)

- 4 PC light 1000W with 4 floor stand and aluminum tape

- 6 Quartz 500 W

- 4 Foot lights T4

- A dimmable fog machine

- 4 lighting stands with 4 bars (round, diameter 49mm)

- 1 dimmer 24 circuits at 2 Kw with 2 sockets for each circuit (otherwise plan power strips).

- 2 electrical multicables at 8 circuits of 15 meters and 2 at 8 circuits of 20 meters.

- Extensions cords: 5 of 20 meters, 20 of 10 meters, and 20 of 5 meters.

- 20 power strips.

- One 5 pin-DMX cable of 20 meters (link dimmer-lighting booth) and 2 of 10 m.

- Plan 1 screw gun with drills and bits screwdrivers.

- Plan tools (screw drivers, wrenchs ...)

Plan a public lighting dimmable according to the place, dimmable via lighting booth.

Plan light to strike.

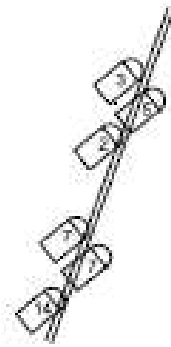
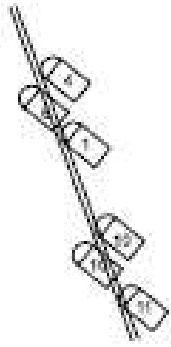

plan de feu
...Sodade...
sans échelle

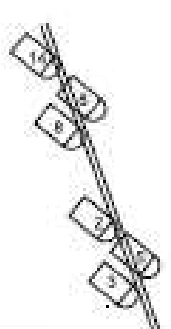
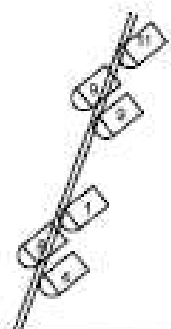
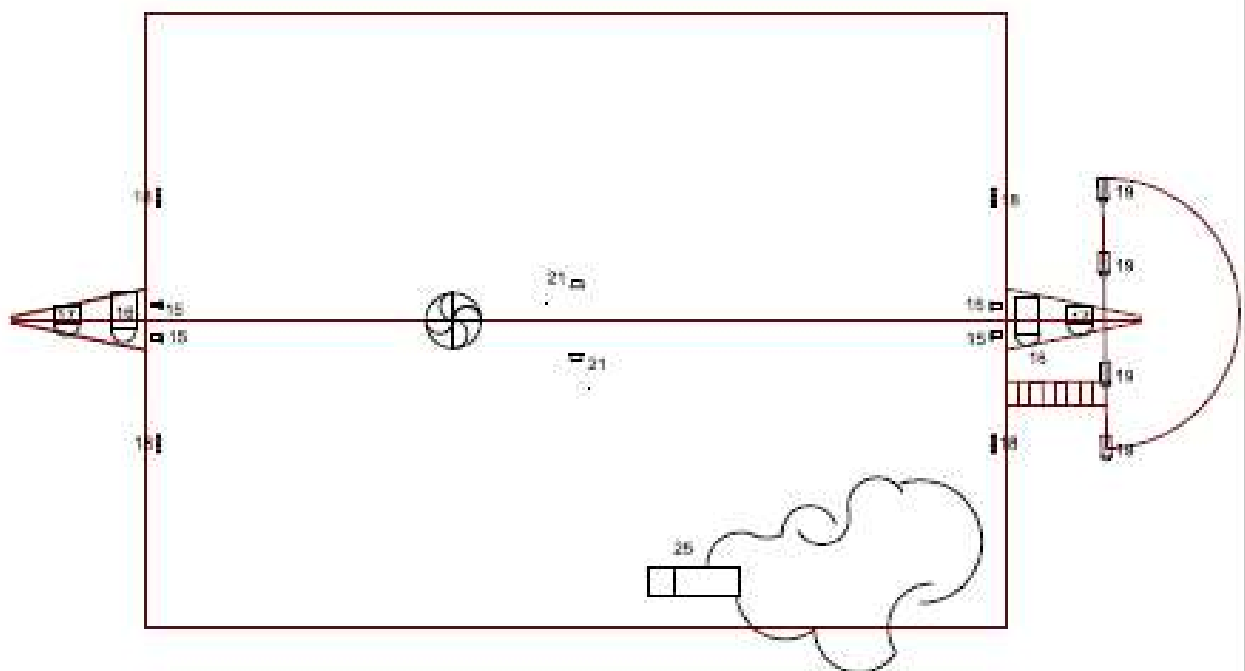

-Sound:

The music is played live by a musician (double-bass, keyboard, computer and loop station) and a singer (with a loop station).

The company provides only keyboard and loop station.

List of equipment required from the organizer :

- 1 yamaha 01 V 96 (English Version)
- 1 snake 12/8 of 25 meters.
- 2 Direct Box.
- Microphone : 1 shure Beta 58, 1 Shure SM 58 and 1 shure beta 52 A
- 1 mike stand and 1 stable mike stand (with round base)
- 3 Instruments cables (6.3 mono Jack) of 5 meters.
- microphone cable : 5 of 10 meters and 10 of 5 meters.
- Adapter : 5 XLR male- stereo jack male and 3 XLR female- stereo jack male.
- 1 stage Tent (like « vitabri » or “protent”) with weights, 1 table and 2 chairs for sound and light technician.
- 1 Double bass 3/4 or 4/4 (D neck) , Solid wood body (no plywood), Fishman Full Circle upright bass pickup, fixed on the bridge, Strings like Spirocore orchestra, medium tension.
- 1 18” bass drum with pedal (Kick).
- 2 115 XP L-acoustics monitors with amplifiers/processor, the required cabling. It should be independent.

The sound system is to be expected depending on the location and the audience, contact the technical manager to validate the sound system.

For example in L-acoustics : 12 Karas + 8 SB18 (6 Karas and 4 SB18 in each side)

-Staff needs:

- A sound technician for the assembly and tuning of the P.A. and for the disassembly.
- A light technician for the installation, focus and the disassembly.

-Security:

-Security is mandatory if the place hosting the show is not secured, or during the public opening of the site.

-Security is mandatory the day of the installation during lunch time and between the end of the installation and the beginning of the show.

-If the show is done several days, security is also mandatory between each show.

- Dressing room:

- Plan one or several dressing room able to host 9 persons with access to water, lavatory, looking glasses and warm-up space. These dressing rooms should be possible to lock and warmed. The dressing room should be accessible from the start of installation to the end of the uninstallation.

-Water, coffee, tea, fruit juices as well as snacks are welcome.

-Catering and housing:

-9 to 13 persons are present on the tour; please refer to the contract for the number of people and rooms.

-1 person is vegetarian and 1 lactose and gluten intolerant.

-Weather:

-As the show is outdoors, the company takes rights to cancel the show if bad weather conditions (rain, high humidity, strong winds, and snow or low temperatures) make the show hazardous for the staff.

- Planning:

The planning can be changed according to the place, sunset, travel time, installation type and time of the show:

-Day D -2: 10h to 12h30: unloading container, installation of the structure, **plan a screw gun.**

12h30 to 14h00: lunch, plan security of the trailer.

14h00 to 18h30: Installation of the structure, Installation of sound and lights, 1 sound technician and 1 light technician. Sound tests (make sure there is no other show during this time or background noises), structure test.

18h30 to 21h00: Pauses, dinner, plan a security of the trailer.

22h to 23h: focus and light tests for the tightrope walkers

From 18h30: plan a security of the trailer (with a guard).

-Day D-1: plan a security of the trailer (with a guard).

11 h to 13h: rehearsal for circus performers if necessary.

15 h to 18 h: rehearsal for circus performers if necessary.

21 h to 23 h: rehearsal for circus performers with the musicians, the sound and light.

-Day D: plan a security of the trailer (with a guard).

19 h 00 to 20 h 30: circus performer warm up on the structure.

20 h 30 to 22 h 00: sound and light checks.

22h to 23h: (according of the representation timing) Show.

From 23h: plan a security of the trailer (with a guard).

-Day D 1: plan a security of the trailer (with a guard).

19 h 00 to 20 h 30: circus performer warm up on the structure.

20 h 30 to 22 h 00: sound and light checks.

22h to 23h: (according of the representation timing) Show.

23h30 to 1h30: Uninstallation of the sound, lights and structure, plan one sound technician and one light technician **plan a screw gun**. Plan 1 stage Tent (like « vitabri » or “protent”) with weights to stock our fragile material.

Night: plan a security of the trailer (with a guard).

-Day D 2: plan a security of the trailer (with a guard).

11 h to 13 h: Load trailer and smaller items into container.

Technical manager: Clément AGATE
(0033) 6 79 28 41 17
clem.agate@gmail.com